

REVISIONS:

REV.	REV. ISSUE
1	05/10/2022

[illegible]

2203

**GATEWAY LUXURY
APARTMENTS**

LOCATED AT:
950 N POWERLINE ROAD,
POMPANO BEACH FL 33069

DORGO LUNZA & ASSOCIATES
1248 S ALHAMBRA CIRCLE
CORAL GABLES, FL 33146
(786) 554-9035
AIA 38052598
WWW.BURGOSLANZA.COM
PABLO BURGOS ARCHITECT AR 0085925
CARLOS LUNZA ARCHITECT AR 0016081
S LUNZA ARCHITECTS AND ARE
EXPRESS WRITTEN CONSENT OF THE SAME

**BURKUS
LANZA**
ARCHITECTS & PLANNERS
AA 26001519

CONTRACT 9261 SERVICES
THE ARCHITECTURAL
DESIGN AND DETAIL DRAWINGS ARE THE LEGAL PROPERTIES OF THE FIRM AND ARE TO BE USED ONLY FOR THE PROJECT AND INSTRUMENTS OF SERVICE NOT TO BE REPRODUCED IN WHOLE OR IN PARTS

Pablo
Burgos

Digitally signed by Pablo Burgos
DN: cn=Pablo Burgos, o=Burgos
Lanzan & Assoc., ou=AR95925,
email=pburgos@burgoslanza.co
m, c=US
Date: 2022.05.11 14:28:49 -04'00'

DATE	11/09/21
DRAWN	CR
PROJECT No.	2203
SCALE	AS-SHOWN

ITE COLUMNS

$1/2" = 1'-0"$

22

PZ22-12000008
6/15/2022

DRC
PZ22-12000008
8/17/2022

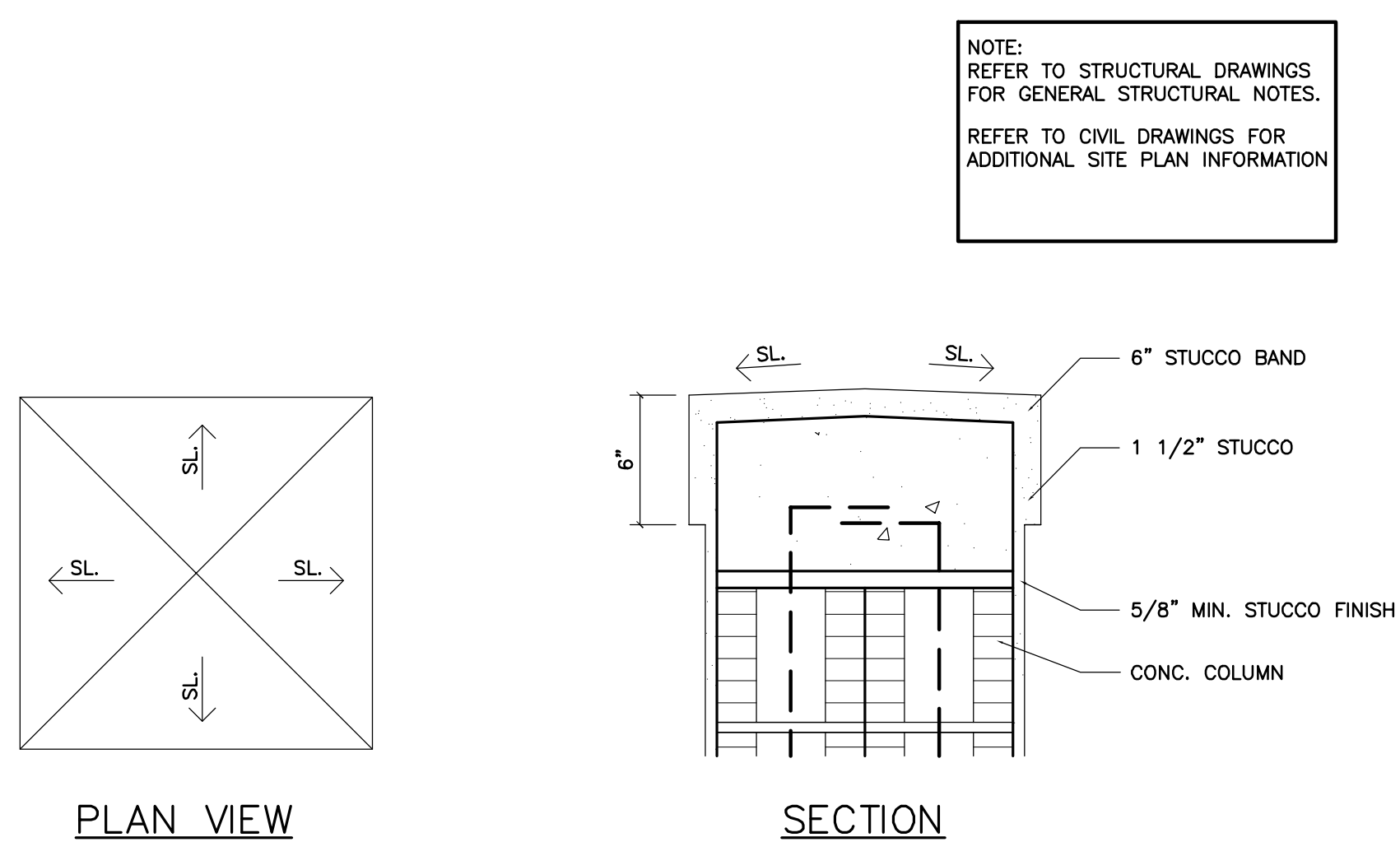

④ CONCRETE CAP DETAIL

SCALE: 1 1/2" = 1'-0"

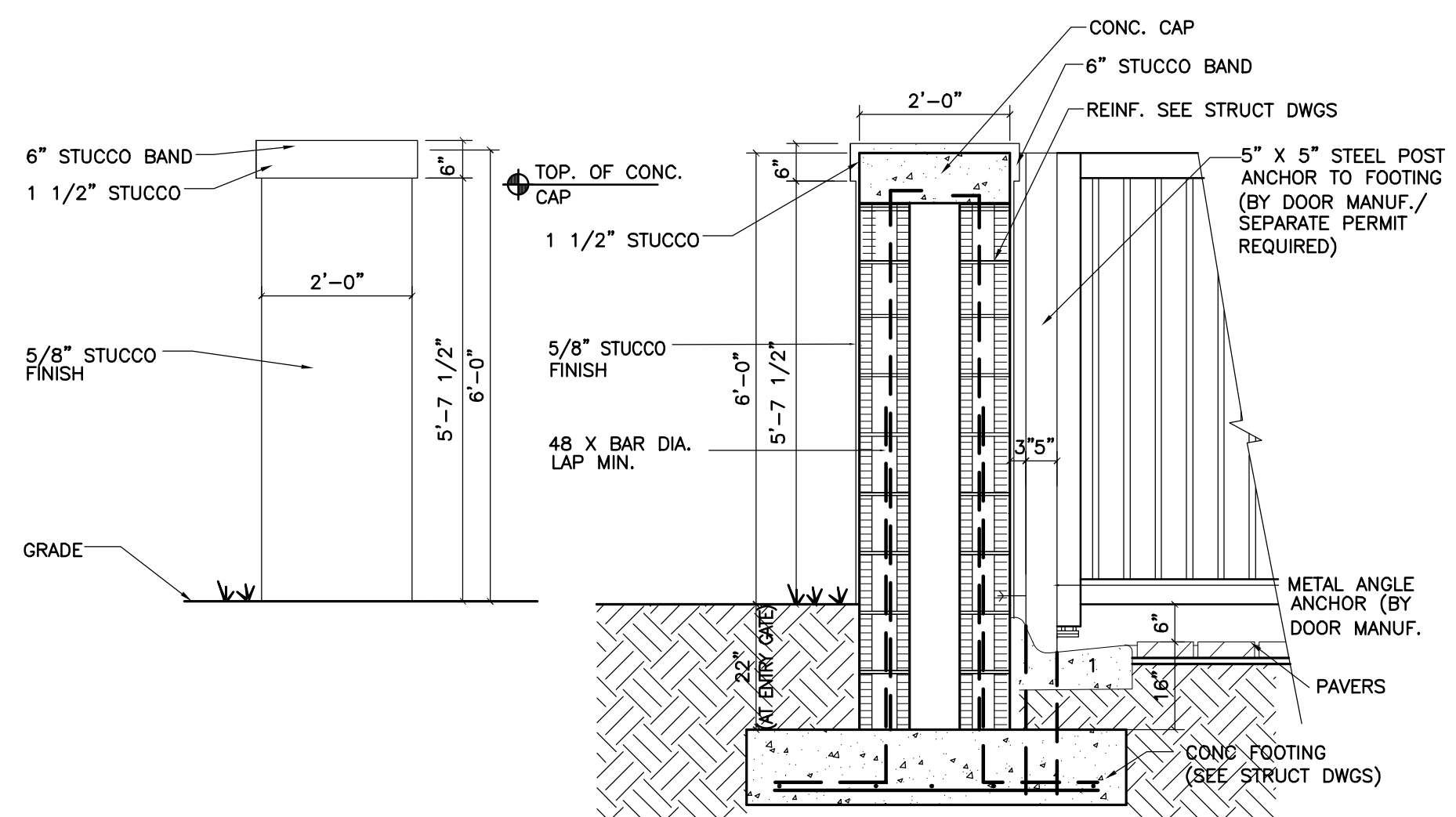
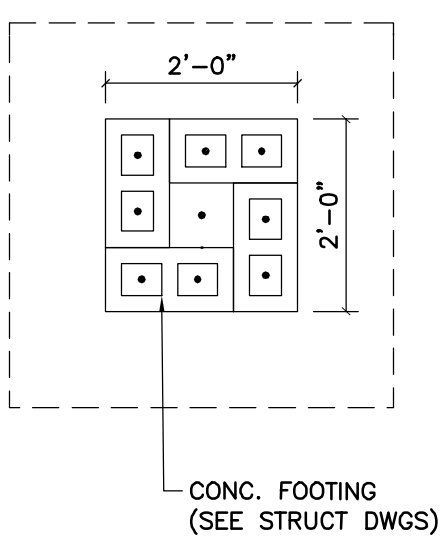

① COLUMN TYPE "A"

24" X 24" X 6'-0"(H)

SCALE: 1/2" = 1'-0"